

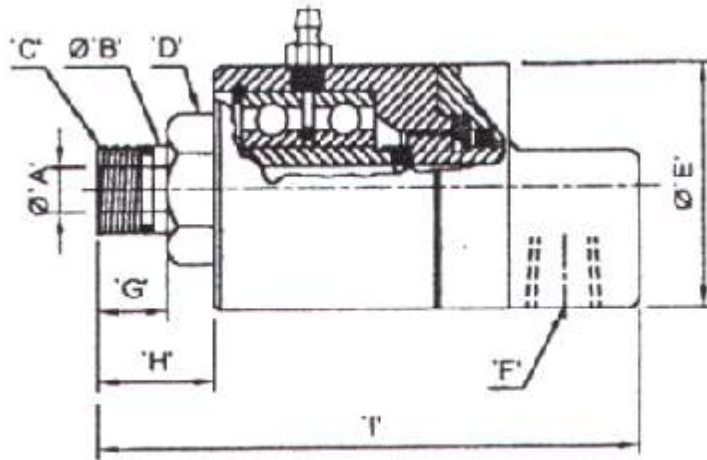

R-600 90° & STRAIGHT THROUGH ROTARY UNIONS

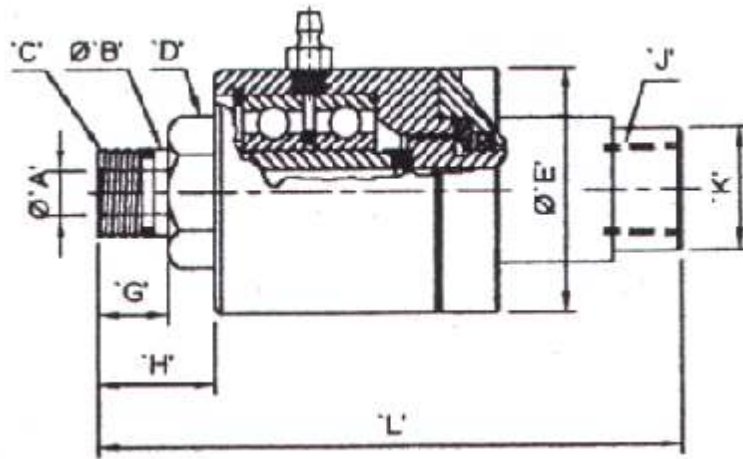

R-600 90° ROTARY UNION



R-600 STRAIGHT THROUGH ROTARY UNION

Housing with Straight Through or 90° entry for high pressure, high speed service Sealing faces Available with Tungsten Carbide and Ceramic

OPERATING DATA:

Max Speed - 10,000 RPM
 Max. Temperature - 120°C
 Max Pressure - 68 kg./cm²
 Media - Coolant Fluid

MODEL	'A'	PILOT 'B'	'C' ROTOR THREAD BSP / UNF / METRIC	'D' ACROSS FLAT	'E'	'F' BSPT	'G'	'H'	'I'	'J' BSPT	'K' ACROSS FLAT	'L'
R 0600-003-050	8	16.02	M16X1.5 PITCH LH	22	44	3/8"	16.5	27	104.2	1/4"	22	111
R 0600-003-056	8	15.87	5/8" UNFX18 LH	22	44	3/8"	16.5	27	104.2	1/4"	22	111